

HOW TO INSTALL BILLBOARD & SIDE PANEL

* 30 BALLS are in the elevator.

1

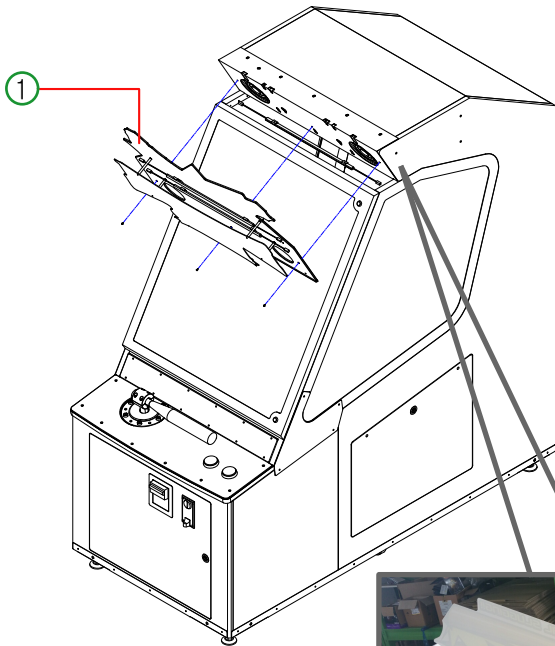

- Put ① BILLBOARD ASS'Y on top of cabinet and assemble it with the fixed bolts [M6 Bolts, 3EA]

* Install the billboard to the machine adjusting diagonally and then use the M6 bolt in the 3 holes.

- ② Connector [cabinet] and is connected to the BILLBOARD ASS'Y



3



- You complete it like picture.

2

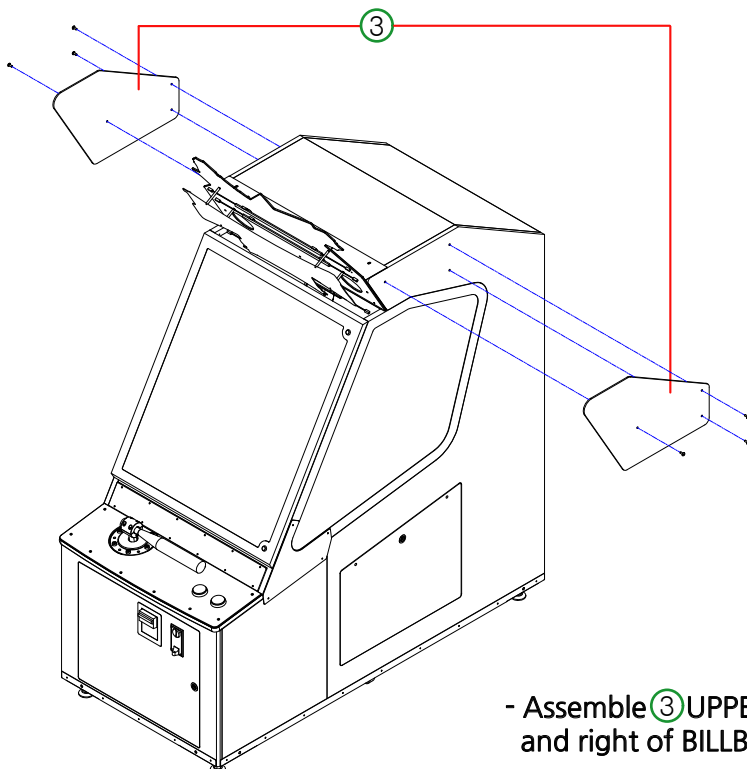

- Assemble ③ UPPER SIDE DECO ACRYL L,R on left and right of BILLBOARD UPPER SIDE [EACH M6 Bolts, 3EA]